

Name: Tyler Whitt

Date: July 2019 Event: Friday Night Financial



City: Brookfield State: WI

Track: Trackside Hobbies and Raceway

Track Dirt Carpet Tight Smooth Hard Packed Dry Grip Level: Low Medium High
Conditions: Clay Astro Turf Open Rough Loamy Wet Tread Level: Pin Ghost Pin Slicks

Front Suspension

Toe: +/- 0 deg Camber: -1 deg
Ride Height: 20mm (body on) Caster Block: 0° 5°
Kick Shim(s): 2mm 1mm Wedge(20°) Other:
VLA Setting: Short Arm Long Arm
Front Pivot: Alum Composite Brass
Pivot Height: SLRC LRC MRC HRC
Piston: 2x1.6 Thin (TLR333014) Oil: 37.5wt TLR
Limiters: Internal: - External: - Stroke: 23.5mm
Shock Eyelet: Std. +2 Shock Location: 2 - Middle
Spring: AE V2 Gray (ASC91832) Sway Bar: 0.8mm
Spindle Steering Arm: 4 5 6
Spindle Ball Stud: Standard Low Spacers:
Draglink Ball Stud: Standard Low Spacers:
Axle Spacing: 0 +0.5mm +1mm
Trail: 2mm 3mm 4mm
Camber Link, Inner: 1 2 3 Outer: A B
Tower: Stiffezel Carbon Carbon +2mm
Mud Guard: Soft Standard Stiffezel
Front Wheels: Standard Stiffezel
Front Wing: Low High Narrow High Wide

Stiffezel Parts:

Front Arm Rear Arm
Chassis Brace/Waterfall

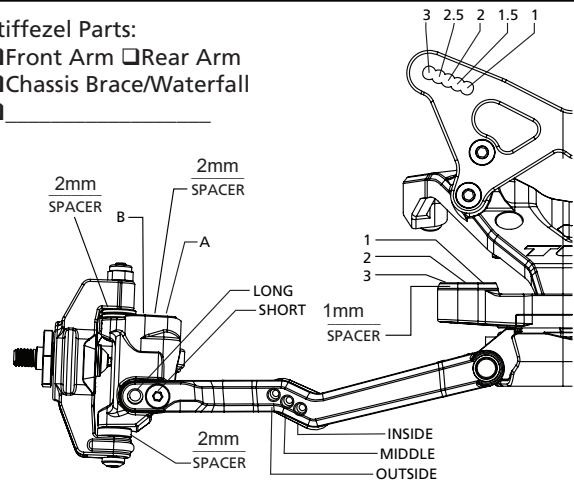

Notes:

Rear Suspension

Configuration: Laydown Standup
Diff. Height: 0 +1 +1.75 +2.5 +3.5
Axle Height: 0 +1 +2 +3 +4
Ride Height: 20mm (body on) Camber: -1 deg
Hub Spacing: 1.5mm Fr 1.5mm Rr Hex Width: Std
Piston: 1x1.6 + 1x1.7 (TLR333015) Oil: 32.5wt TLR
Spring: AE V2 Blue (ASC91840) Sway Bar: -
Limiters: Internal: - External: - Stroke: 29.0mm
Shock Eyelet: Std. +2 Shock Location: 2 - Middle
Shock Mounting: Front Rear Shaft Dia.: 3.0 3.5
Tower: Stiffezel Carbon Carbon +2mm
Camber Block Spacer: 1mm ↓ 0mm 1mm ↑
Camber Link, Inner: 1 2 3
Camber Link, Outer: A B C
Battery Position: 1 2 3 4 5
Wing/Wickerbill: TLR 6.5" Lowest Cut
Wing Angle: 0° 2° 4° Wing Height: Raised 2mm
Diff Type: Ball Gear Setting: One Tire Rotation
Gear Diff Gears: Composite Steel Planet Gears: 2 4
Driveshaft Length: CVA Universal Length: 68mm
CV Pin Position: 1 2 3 4
Direct Drive Slipper Pads: Torque (yel) Drive (org)

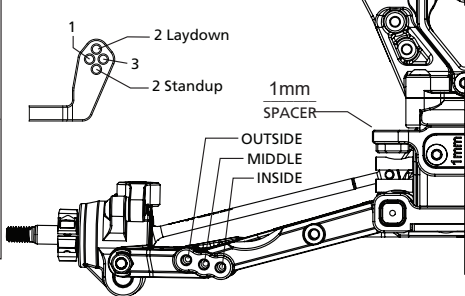
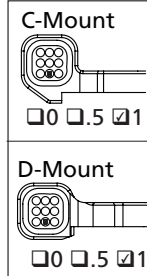
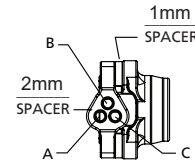
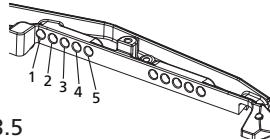
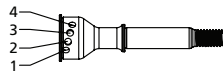

Electronics

Radio: M12s Timing Advance: -
Servo: Spektrum S6240 Steering Expo: -5%
ESC: XR10 Pro G2 Throttle/Brake EPA: 100/78
Motor: Motiv MC2 7.5t
Initial Brake: - Pinion: 21 Spur: 78
Drag Brake: - Battery: Motiv Defy 6
Throttle Profile: - Battery Weight: -

Tires

	Front	Rear
Thread:	PL Electron	PL Positron
Compound:	S4	S4
Insert:	Stock PL	Stock PL
Sauce:	J5D Nexum	J5D Nexum

Notes:

Chassis

Electronics Plate Brass, 36g Carbon
Battery Plate 19g 26g 37g
Rear Ballast 16g 25g
C-Pivot Block Brass, 20g Aluminum
Total Weight: 1590g
FR: % RR: %